



# Technical data sheet

# A17-M



Download documents



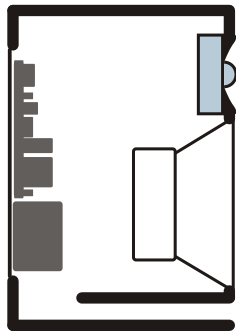

## PSI Audio Original Technology



PSI Audio Hand Made  
Neodymium Tweeter

**CPR** Compensated Phase Response system  
**AOI** Adaptive Output Impedance system  
**PSC** Phantom Standby Control

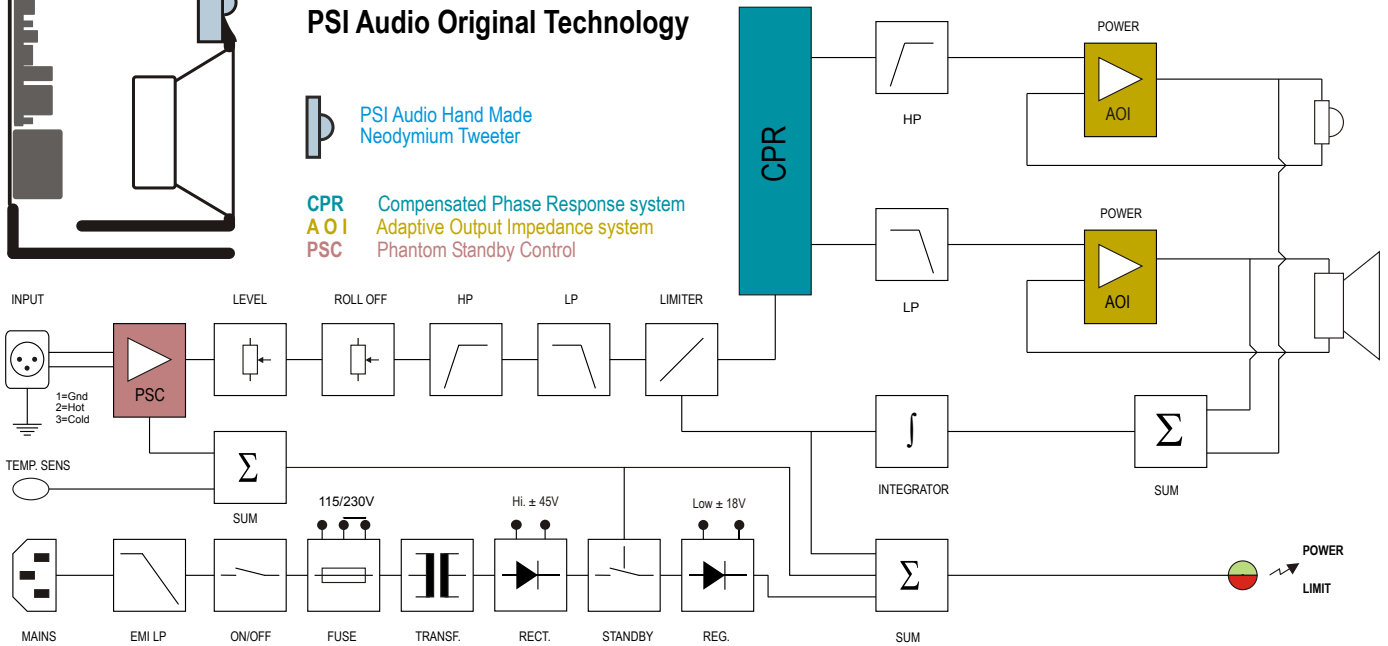

Potential peak power	170+45	W	Woofer ext. diam.	7.1	in
RMS power	47+7	W	W. diaphragm diam.	130	mm
Input impedance	Sym 10 kΩ	Ω	W. diaphragm diam.	5.1	in
Input sensitivity	0.775	V <sub>rms</sub>	Tweeter ext. dim.	90	mm
Input overload	24	V <sub>pp</sub>	Tweeter ext. dim.	3.5	in
Continuous max SPL@1 m	102	dB	T. diaphragm diam.	27	mm
Short term max. SPL@1m	105	dB	T. diaphragm diam.	1.06	in
Peak max. SPL@1m	115	dB	Dimensions W x H x D	200 x 320 x 230	mm
Background noise @1m	6	dB <sub>A</sub>	Dimensions W x H x D	7.9 x 12.6 x 9.1	in
Signal to noise ratio (S/N)	96	dB <sub>A</sub>	Net Weight	7.4	kg
Mechanical noise (i.e. transformer)	-9	dB <sub>A</sub>	Net Weight	16.3	lbs
Bandwidth at -6dB	44-23'000	Hz	Input connector	1 x XLR F / 3P	
SPL tolerances	±2.2	dB	Input connections	1=GND, 2=(+), 3=(-)	
Phase tolerances	± 45 (300 Hz – 20 kHz)	deg	Mains voltage	115 / 230(50-60Hz)	V, ±10 %
Dispersion (H x V)	75 x 40	deg	Mains max DC offset	0.47	V
Directivity Factor	SEE GRAPH		Standby consumption	1.3	W
Acoustic Power	SEE GRAPH		Quiescent consumption	8	W
Distortion THD	SEE GRAPH		Max continuous Power	100	W
System	2	ways	RMS continuous consumption	72	W
Crossover frequency	3'500	Hz	Max Relative humidity	70	%
Box Material	MDF		External temperature range	5-35	°C
Woofer ext. diam.	180	mm	Warranty	5 (+1)	years

### Measurement environment:

- Large anechoic room, Temperature 23±2°C, Humidity 50±20%
- Typical acoustical measurements, Tolerances ±0.5 dB Averaging 1/6 Octave

## Frequency Response

- SPL@ (-10dBu ; 1m)
- SPL with -10dB Roll Off
- Acoustic Power

Resolution: 1/48 Octave  
Smoothing: 1/6 Octave

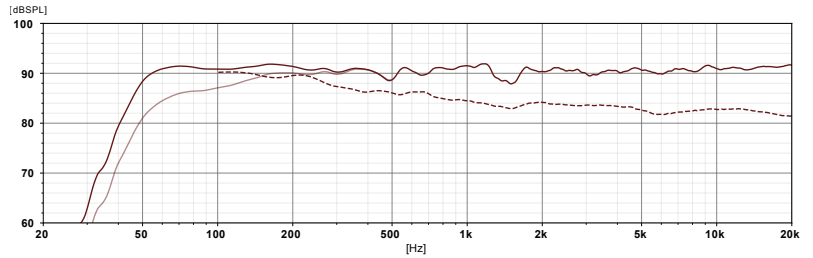

## Total Harmonic Distortion

- THD@(-10dBu;1m)

Resolution: 1/48 Octave  
Smoothing: 1/6 Octave

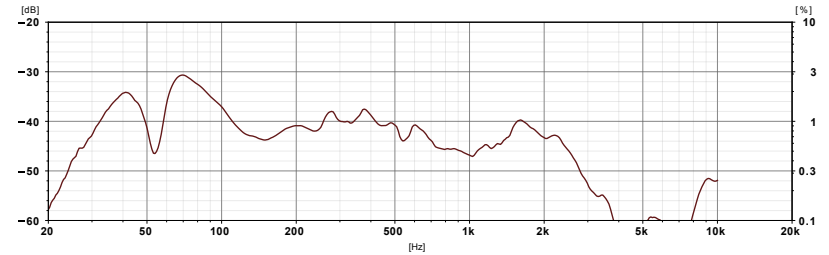

## Acoustic Phase

- Acoustic Phase

Delay: 0.26 [ms]  
Resolution: 1/48 Octave  
Smoothing: 1/6 Octave

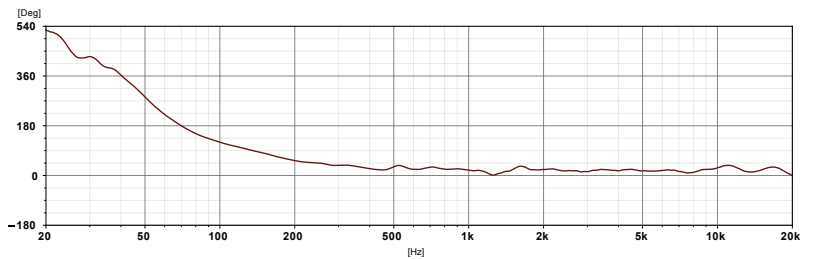

## Max Continuous SPL

- Max Continuous SPL @ 1m

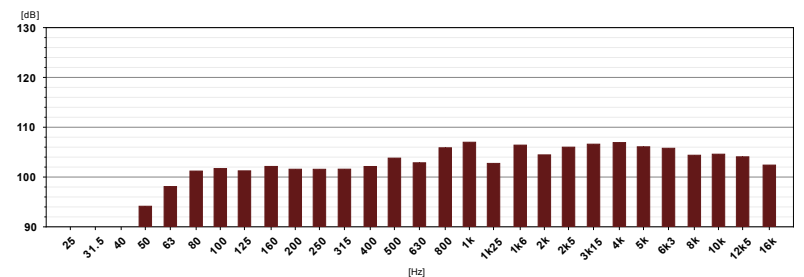

## Directivity Index

- Directivity Index

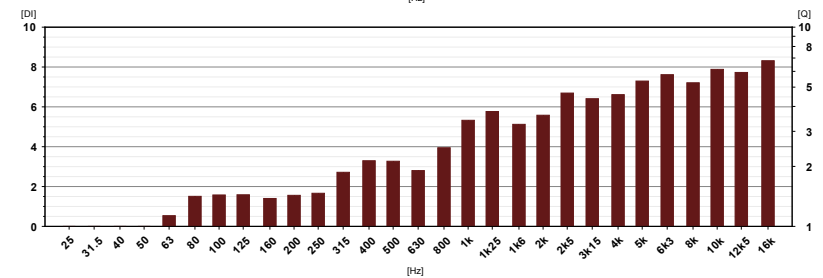

## Horizontal Directivity

Frequency resolution: 1/36 Octave  
Smoothing: 1/3 Octave

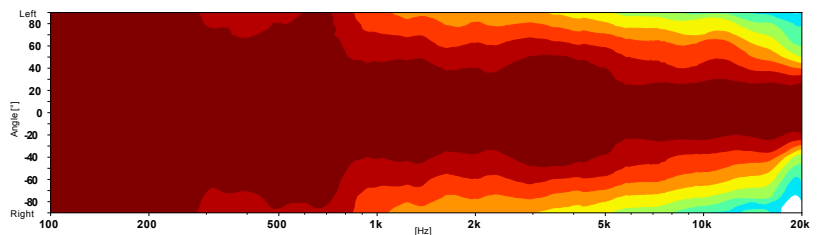
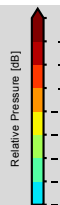

## Vertical Directivity

Frequency resolution: 1/36 Octave  
Smoothing: 1/3 Octave

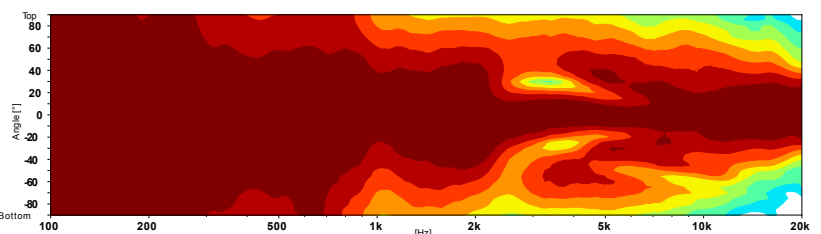
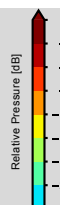

## Mounting

All dimensions are in mm

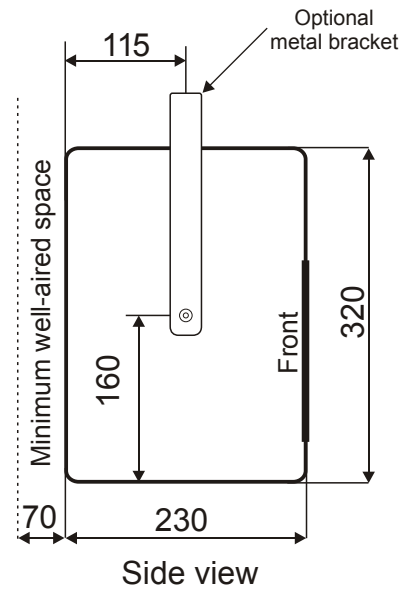
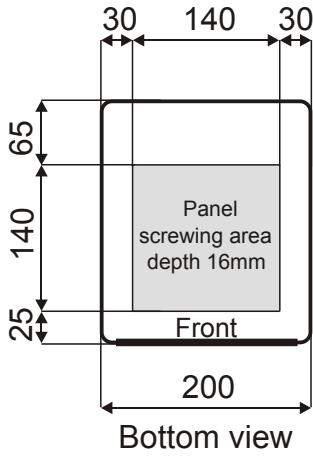

Refer to user manual for information about installation and safety instructions

## Acoustical axis

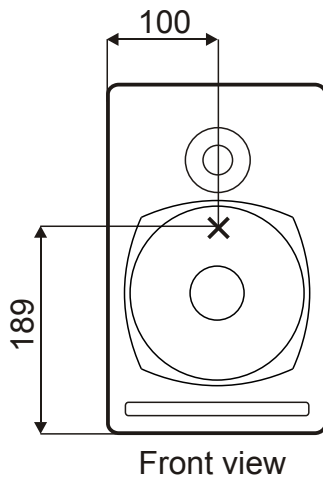

## Recommended listening distance

